

# K0625L (latching pull type)

## DRAWING (mm)

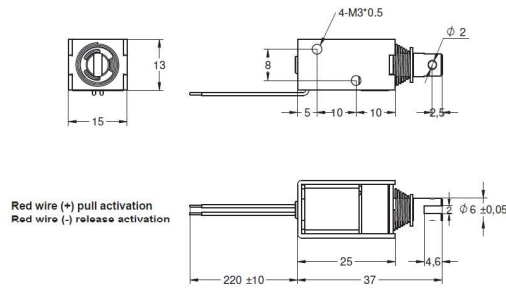

## PHOTO



## MODEL NO. DESIGNATION

K0625L - VOLTAGE  
Example: K0625L-12V

## SOLENOID DATA

Duty cycle / ED (%) ▶	Continuous (100%)	Intermittent (50%)	Intermittent (25%)	Intermittent (10%)	
Watts @ 20°C ▶	2,5	5	10	25	
Maximum time in energized state (in seconds) ▶	∞	60	34	7	
Part ▼	Resistance (20°C) ± 10% (Ω) ▼	DC Volts (V) ▼			
K0625L-06V	14,4	4,2	6	8,5	13,4
K0625L-12V	57,6	8,5	12	17	26,8
K0625L-24V	230,4	17	24	34	53,6

## SOLENOID FEATURES AND STANDARD DATA

	STANDARD	CUSTOMIZATION OPTIONS
Type	Pull type latching DC solenoid	Push type DC solenoid
Cable	Flying wire 230mm	Length, type and connector
Voltage	6 to 24 VDC @ 100% ED	Other voltages upon request
Life time	At least 500.000 single strokes	
Plunger material	Carbon steel 12L14	
Protection class	IP00	
Insulation grade	B	
Operating temperature	-5°C ... +40°C	
Manufacturing quality standards	ISO9001:2008, ISO/TS 16949:2002	
RoHS compliance	Yes	
CE approval	No	
UL approval	No	

## ADDITIONAL DATA

Holding force, permanent magnet	300g
Weight	26g
Return spring	Yes

## SPRING DATA

Loading force @ 1mm compression	30g
---------------------------------	-----

## PLUNGER PROFILE



## DIAGRAM

