

B86112 / Ø 86mm

DRAWING (mm)

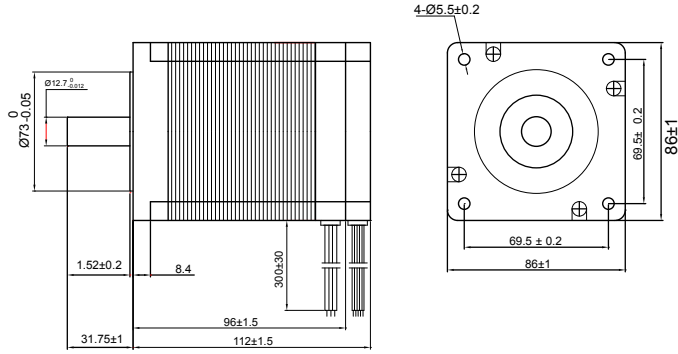

PHOTO



HALL CONNECTING

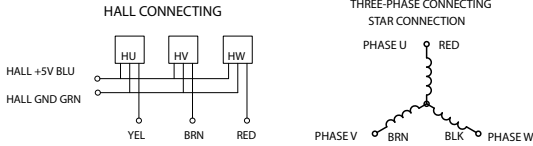

MODEL NO. DESIGNATION

MODEL - VOLTAGE

Example: B86112-12

MOTOR DATA

	Units	B86112-24	B86112-48		Units	B86112
Nominal voltage	V	24	48	Nominal voltage	V	24 48
Nominal power	W	393	436	Ambient temperature	°C	--15...+40
No load speed	rpm	3870	3600	Max. permissible winding temperature	°C	140 120
No load current	mA	2400	1200	Max. permissible speed	rpm	5000
Nominal speed	rpm	3126	2975	Axial play at axial load < 3,5 N	mm	0,1
Nominal torque	Nm	1.2	1.4	Axial play at axial load > 3,5 N	mm	0,6
Nominal current	A	23	11.8	Radial play	mm@g	0,02
Stall torque	Nm	6.2	8	Max. axial load (dynamic)	N	60
Starting current	A	108	62	Max. force for press fits (static)	N	560
Max. efficiency	%	74.1	77.6	Max. force for press fits (static, shaft)	N	2000
Terminal resistance phase to phase	Ω	0.04	0.16	Max. radial loading, 10 mm from flange	N	220
Terminal inductance phase to phase	mH	0.096	0.5	Number of pole pairs		4
Torque constant	Nm / A	0.0586	0.13	Number of phases		3
Speed constant	rpm / V	160	75	Weight	g	3150
Speed / torque gradient	rpm / Nm	624	450			
Mechanical time constant	ms	10.6	7.7			
Rotor inertia	gcm ²	1600	1600			