

WHD80141 / Ø 80mm / 90W / 90W

DRAWING (mm)

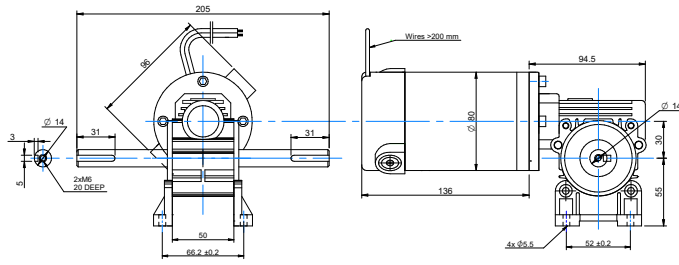

PHOTO



MODEL NO. DESIGNATION

WHD80141 - VOLTAGE - REDUCTION - ME / OE / B

Example: WHD80141-12-10

ME = Magnetic encoder
OE = Optical encoder
B = Brake

ADDITIONAL



Encoder



Brake

GEAR MOTOR DATA

	10:1	15:1	20:1	25:1	30:1	40:1	50:1
Reduction	10:1	15:1	20:1	25:1	30:1	40:1	50:1
Nominal torque 12 V (Nm) *	2.5	3.3	4.2	5.2	5.7	6.0	7.3
Nominal speed 12 V (rpm) *	245	163	122	98	81	61	49
Nominal torque 24 V (Nm) *	2.5	3.3	4.2	5.2	5.7	6.0	7.3
Nominal speed 24 V (rpm) *	245	163	122	98	81	61	49
Length (mm)	230	230	230	230	230	230	230
Weight (kg)	5.6	5.6	5.6	5.6	5.6	5.6	5.6

* Nominal speed and nominal torque have a tolerance of $\pm 15\%$

GEAR HEAD DATA

	10:1	15:1	20:1	25:1	30:1	40:1	50:1
Reduction	10:1	15:1	20:1	25:1	30:1	40:1	50:1
Max. continuous torque (Nm)	12	14	16	18	20	20	20
Intermittently permissible torque (Nm)	15	17	19	22	24	24	24
Efficiency (%)	72	65	62	60	46	44	42
Weight (kg)	1.6	1.6	1.6	1.6	1.6	1.6	1.6

GEAR MOTOR FEATURES AND STANDARD DATA

	STANDARD	CUSTOMIZATION OPTIONS
Type	Worm gear brush dc gear motor	
Gear angle	Left	
Motor type	Iron core, brush commutation	Winding parameters
Motor brush type	Carbon brushes	
Motor terminals	Cable wires 200 mm	Wiring harnesses, cables, connectors
EMC filter	No	Yes
Gear	Plastic	Metal
Bearing	Ball bearing	
Shaft	Hardened stainless steel	Dimensions
Environmental protection	IP55 (with encoder or brake IP50)	
Operating temperature	-10...+60 °C	-40...+60 °C
RoHS compliance	Yes	
CE label	No	Yes
UL approval	No	Yes
UL approval	No	Yes

MOTOR DATA

Nominal voltage (V)	12	24
No load speed (rpm)	2800	2800
No load current (A)	2.5	1.2
Nominal speed (rpm)	2450	2450
Nominal torque (Nm)	3.5	3.5
Nominal current (A)	9.6	4.8
Stall torque (Nm)	2.2	2.2
Starting current (A)	74	37
Output (W)	90	90
Length (mm)	144	144
Weight (kg)	4	4