



BRUSHLESS DC MOTORS | 4 - 657W

Transmotec sell a broad range of brushless DC motors in standard and customized configurations. Our motors are often available with gear heads, encoders and wire harnesses. Transmotec is the ideal supplier source especially to instrument and apparatus builders. We keep a high number of motors in stock for immediate delivery.

Customizations include:

- ✓ Customized harness
- ✓ Shaft configuration
- ✓ Winding configuration
- ✓ And more...

TABLE OF CONTENTS

Part name	Diameter (mm)	Length (mm)	Nominal voltage (V)	Nominal speed (rpm)	Nominal torque (mNm)	Output (W)	Page
BR2245	22	45	12V / 24V	4800 / 4800	9.6 / 9.6	4.3 / 3.8	1
BR2268	22	68	12V / 24V	3500 / 3500	24 / 24	7 / 7	2
BR2826	28	26	12V / 24V	8000 / 8000	8 / 8	5 / 5	3
BR2838	28	38	12V / 24V	10000 / 10000	17 / 17	14 / 14	4
BR2877	28	77	12V / 24V	3700 / 3700	60 / 60	19 / 19	5
BR3337	33	37	12V / 24V	3000 / 3000	26.4 / 26.4	4 / 7	6
BR3380	33	80	24V	10000	48	41.5	7
BR4230	42	30	12V / 24V	5000 / 4000	24 / 24	10 / 8.4	8
BR4260	42	60	12V / 24V	4200 / 4200	67 / 67	25 / 25	9
BR4285	42	85	24V	4000	180	62	10
BR4290	42	90	24V	6300	138	75	11
BR5743	57	43	12V / 24V	4000 / 4000	55 / 55	22 / 23	12
BR5753	57	53	12V / 24V	4000 / 4000	100 / 110	39 / 41	13
BR5773	57	73	12V / 24V	4000 / 4000	220 / 220	94 / 81	14
BR5793	57	93	12V / 24V	4000 / 4000	330 / 330	127 / 120	15
BR57115	57	115	24V	4000	440	172	16
B4240	42	40	12V / 24V	4000 / 4000	75 / 75	26 / 26	17
B4260	42	60	12V / 24V	4000 / 4000	150 / 150	52 / 52	18
B4280	42	80	24V	4000	220	78	19
B42100	42	100	24V	4000	300	105	20
B5755	57	55	24V	4000	110	52	21
B8672	86	72	12V / 24V / 48V	3201 / 2994 / 3102	349 / 357 / 359	117 / 112 / 117	22
B8686	86	86	12V / 24V / 48V	1817 / 3062 / 3107	609 / 703 / 702	116 / 225 / 228	23
B86112	86	112	24V / 48V	3126 / 2975	1200 / 1400	393 / 436	24
B86139	86	139	48V	2990	2098	657	25

BR2245 / Ø 22mm

DRAWING (mm)

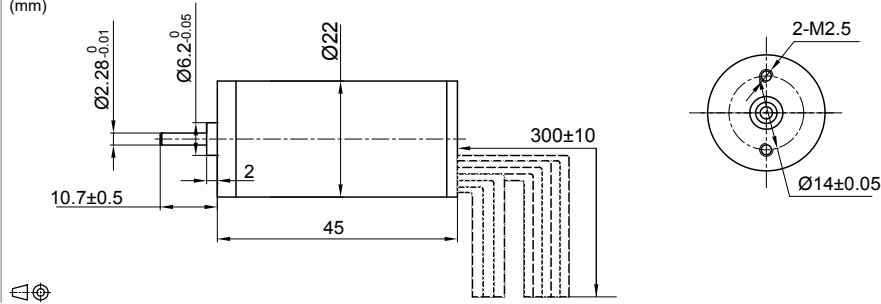

PHOTO



HALL CONNECTING

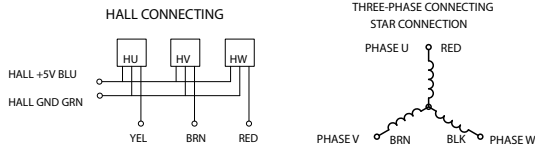

MODEL NO. DESIGNATION

MODEL - VOLTAGE

Example: BR2245-12

MOTOR DATA

	Units	BR2245-12	BR2245-24		Units	B2245
Nominal voltage	V	12	24	Operating temperature	°C	-15...+40
Nominal power	W	4.3	3.8	Max. permissible winding temperature	°C	120
No load speed	rpm	7500	7000	Max. permissible speed	rpm	15000
No load current	mA	40	30	Axial play at axial load < 3,5 N	mm	0.08
Nominal speed	rpm	4800	4800	Axial play at axial load > 3,5 N	mm	0.08
Nominal torque	mNm	9.6	9.6	Radial play	mm@g	0.02@460
Nominal current	A	1.1	0.7	Max. axial load (dynamic)	N	4.4
Stall torque	mNm	20	21	Max. force for press fits (static)	N	4.4
Max. efficiency	%	50	50	Max. force for press fits (static, shaft supported)	N	4.4
Terminal resistance phase to phase	Ω	5.25	23	Max. radial loading, 10 mm from flange	N	4
Terminal inductance phase to phase	mH	1.6	6.2	Number of pole pairs		8
Torque constant	mNm / A	15.84	30.2	Number of phases		3
Rotor inertia	gcm ²	0.66	0.66	Weight	g	70

BR2268 / Ø 22mm

DRAWING (mm)

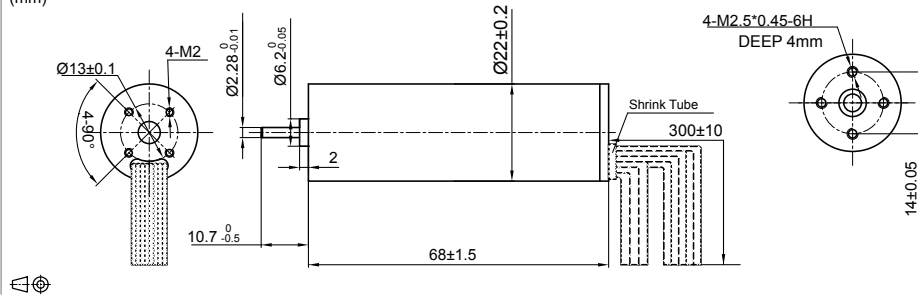

PHOTO



HALL CONNECTING

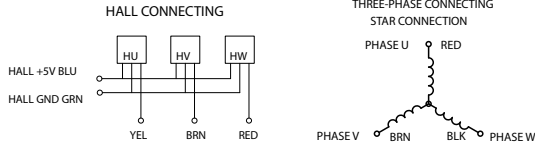

MODEL NO. DESIGNATION

MODEL - VOLTAGE

Example: BR2268-12

MOTOR DATA

	Units	BR2268-12	BR2268-24		Units	BR2268
Nominal voltage	V	12	24	Ambient temperature	°C	-15...+40
Nominal power	W	7	7	Max. permissible winding temperature	°C	120
No load speed	rpm	6000	6000	Max. permissible speed	rpm	15000
No load current	mA	40	40	Axial play at axial load < 3,5 N	mm	0.08
Nominal speed	rpm	3500	3500	Axial play at axial load > 3,5 N	mm	0.08
Nominal torque	mNm	24	24	Radial play	mm@g	0.02@450
Nominal current	A	1.3	0.65	Max. axial load (dynamic)	N	4.4
Stall torque	mNm	48	50	Max. force for press fits (static)	N	4.4
Max. Efficiency	%	56	56	Max. force for press fits (static, shaft supported)	N	4.4
Terminal resistance phase to phase	Ω	2.86	11.8	Max. radial loading, 10 mm from flange	N	4
Terminal inductance phase to phase	mH	1.05	4.2	Number of pole pairs		8
Torque constant	mNm / A	18.22	35.5	Number of phases		3
Rotor inertia	gcm ²	1.32	1.32	Weight	g	120

BR2826 / Ø 28mm

DRAWING (mm)

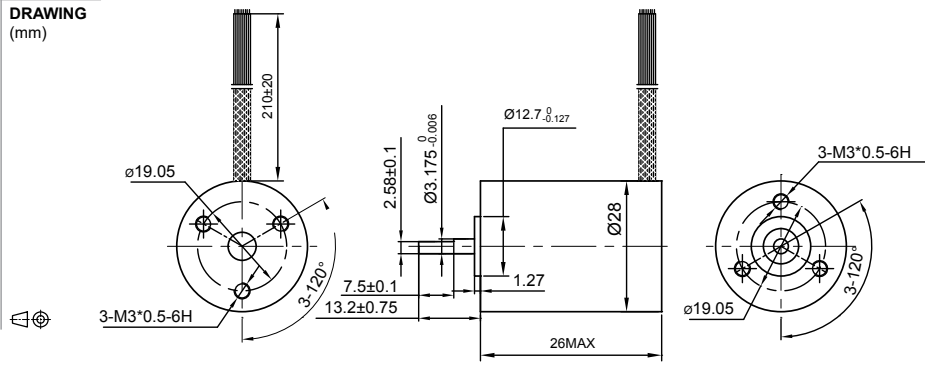

PHOTO



HALL CONNECTING

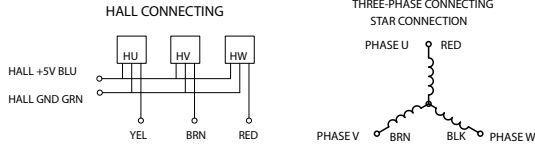

MODEL NO. DESIGNATION

MODEL - VOLTAGE

Example: BR2826-12

MOTOR DATA

	Units	BR2826-12	BR2826-24		Units	BR2826
Nominal voltage	V	12	24	Ambient temperature	°C	-15...+40
Nominal power	W	5	5	Max. permissible winding temperature	°C	120
No load speed	rpm	10000	9600	Max. permissible speed	rpm	15000
No load current	mA	30	30	Axial play at axial load < 3,5 N	mm	0.08
Nominal speed	rpm	8000	8000	Axial play at axial load > 3,5 N	mm	0.08
Nominal torque	mNm	8	8	Radial play	mm@g	0.02@450
Nominal current	A	1.25	1.5	Max. axial load (dynamic)	N	4.4
Stall torque	mNm	21	21	Max. force for press fits (static)	N	4.4
Max. Efficiency	%	50	52	Max. force for press fits (static, shaft supported)	N	4.4
Terminal resistance phase to phase	Ω	5.4	8	Max. radial loading, 10 mm from flange	N	4
Terminal inductance phase to phase	mH	1.68	2	Number of pole pairs		4
Torque constant	mNm / A	10.2	13.7	Number of phases		3
Rotor inertia	gcm ²	2.35	2.35	Weight	g	60

BR2838 / Ø 28mm

DRAWING (mm)

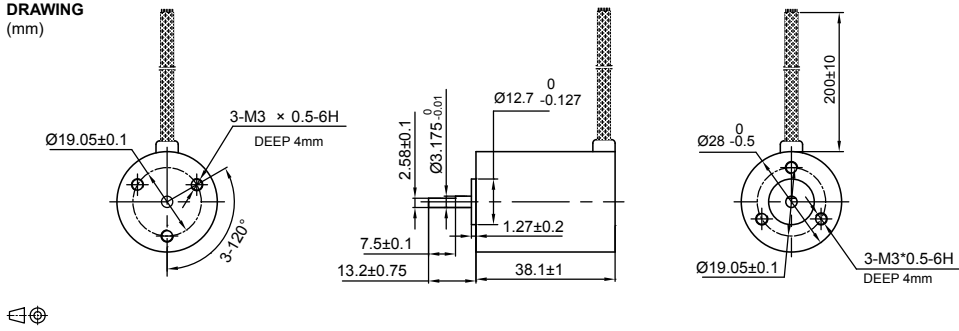

PHOTO



HALL CONNECTING

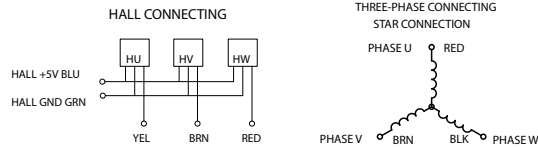

MODEL NO. DESIGNATION

MODEL - VOLTAGE

Example: BR2838-12

MOTOR DATA

	Units	BR2838-12	BR2838-24	Units	BR2838
Nominal voltage	V	12	24	Ambient temperature	°C
Nominal power	W	14	14	Max. permissible winding temperature	°C
No load speed	rpm	13000	13000	Max. permissible speed	rpm
No load current	mA	30	40	Axial play at axial load < 3,5 N	mm
Nominal speed	rpm	10000	10000	Axial play at axial load > 3,5 N	mm
Nominal torque	mNm	17	17	Radial play	mm@g
Nominal current	A	2	2,5	Max. axial load (dynamic)	N
Stall torque	mNm	45	45	Max. force for press fits (static)	N
Max. Efficiency	%	60	64	Max. force for press fits (static, shaft supported)	N
Terminal resistance phase to phase	Ω	1,1	4,2	Max. radial loading, 10 mm from flange	N
Terminal inductance phase to phase	mH	0,4	1,69	Number of pole pairs	
Torque constant	mNm / A	10	16	Number of phases	
Rotor inertia	gcm ²	3.69	3.69	Weight	g

BR2877 / Ø 28mm

DRAWING (mm)

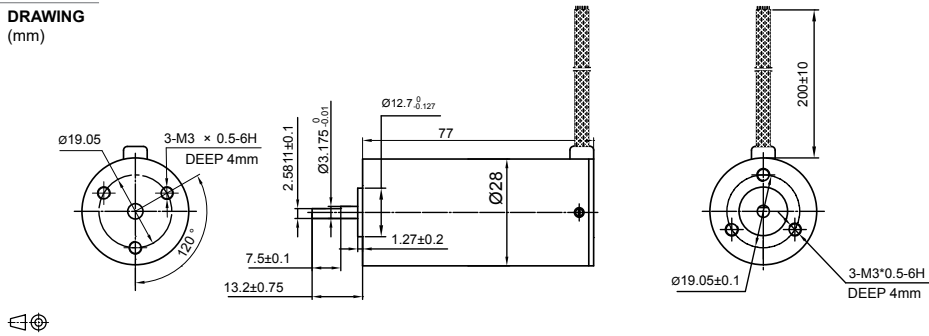

PHOTO



HALL CONNECTING

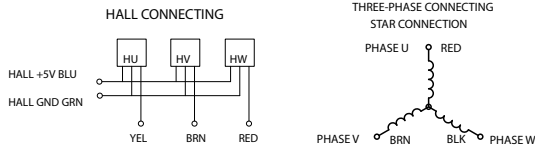

MODEL NO. DESIGNATION

MODEL - VOLTAGE

Example: BR2877-12

MOTOR DATA

	Units	BR2877-12	BR2877-24		Units	BR2877
Nominal voltage	V	12	24	Ambient temperature	°C	-15...+40
Nominal power	W	19	19	Max. permissible winding temperature	°C	120
No load speed	rpm	6000	6000	Max. permissible speed	rpm	15000
No load current	mA	40	40	Axial play at axial load < 3,5 N	mm	0.08
Nominal speed	rpm	3700	3700	Axial play at axial load > 3,5 N	mm	0.08
Nominal torque	mNm	60	60	Radial play	mm@g	0.02@450
Nominal current	A	2.7	4.2	Max. axial load (dynamic)	N	4.4
Stall torque	mNm	150	150	Max. force for press fits (static)	N	4.4
Max. Efficiency	%	65	68	Max. force for press fits (static, shaft supported)	N	4.4
Terminal resistance phase to phase	Ω	1.24	4.2	Max. radial loading, 10 mm from flange	N	4
Terminal inductance phase to phase	mH	0.64	2.2	Number of pole pairs		4
Torque constant	mNm / A	18.3	35.56	Number of phases		3
Rotor inertia	gcm ²	10.98	10.98	Weight	g	200

BR3337 / Ø 33mm

DRAWING (mm)

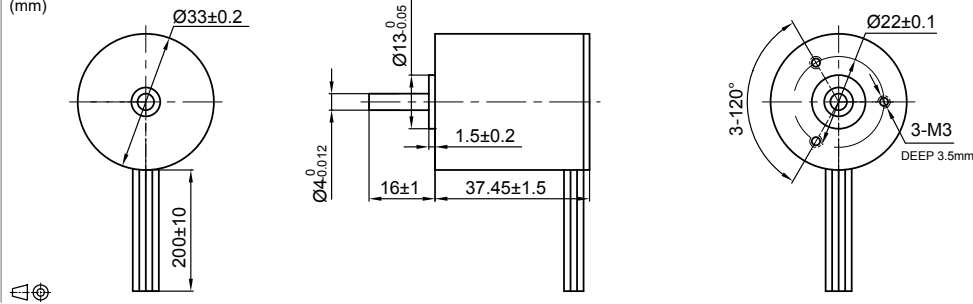

PHOTO



HALL CONNECTING

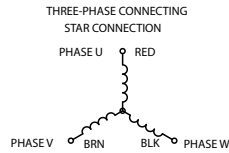
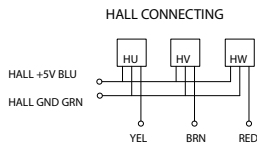

MODEL NO. DESIGNATION

MODEL - VOLTAGE

Example: BR3337-12

MOTOR DATA

	Units	BR3337-12	BR3337-24		Units	BR3337
Nominal voltage	V	12	24	Ambient temperature	°C	-15...+40
Nominal power	W	4	7	Max. permissible winding temperature	°C	120
No load speed	rpm	5000	4500	Max. permissible speed	rpm	15000
No load current	mA	30	30	Axial play at axial load < 3,5 N	mm	0.08
Nominal speed	rpm	3000	3000	Axial play at axial load > 3,5 N	mm	0.08
Nominal torque	mNm	26.4	26.4	Radial play	mm@g	0.02@450
Nominal current	A	0.8	1.5	Max. axial load (dynamic)	N	4.4
Stall torque	mNm	50	66	Max. force for press fits (static)	N	4.4
Max. Efficiency	%	55	56	Max. force for press fits (static, shaft supported)	N	4.4
Terminal resistance phase to phase	Ω	3.4	12.8	Max. radial loading, 10 mm from flange	N	4
Terminal inductance phase to phase	mH	1.8	7	Number of pole pairs		4
Torque constant	mNm / A	23.05	46.09	Number of phases		3
Rotor inertia	gcm ²	7.95	7.95	Weight	g	85

BR3380 / Ø 33mm

DRAWING (mm)

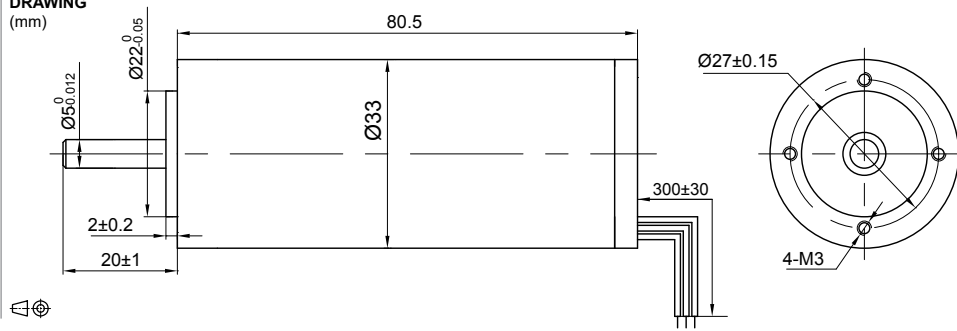

PHOTO



HALL CONNECTING

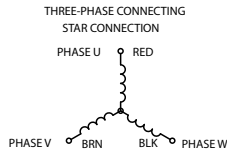
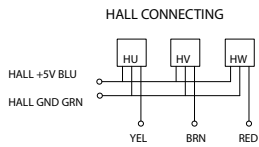

MODEL NO. DESIGNATION

MODEL - VOLTAGE

Example: BR3380-12

MOTOR DATA

	Units	BR3380	BR3337-24		Units	BR3380
Nominal voltage	V	24	24	Ambient temperature	°C	-15...+40
Nominal power	W	41.5	7	Max. permissible winding temperature	°C	120
No load speed	rpm	11000	4500	Max. permissible speed	rpm	15000
No load current	mA	50	30	Axial play at axial load < 3,5 N	mm	0.06
Nominal speed	rpm	10000	3000	Axial play at axial load > 3,5 N	mm	0.06
Nominal torque	mNm	48	26.4	Radial play	mm@g	0.02@450
Nominal current	A	11.5	1.5	Max. axial load (dynamic)	N	4.4
Stall torque	mNm	350	66	Max. force for press fits (static)	N	4.4
Max. Efficiency	%	75	56	Max. force for press fits (static, shaft supported)	N	4.4
Terminal resistance phase to phase	Ω	1.43	12.8	Max. radial loading, 10 mm from flange	N	4
Terminal inductance phase to phase	mH	0.88	7	Number of pole pairs		4
Torque constant	mNm / A	30.62	46.09	Number of phases		3
Rotor inertia	gcm ²	23.55	7.95	Weight	g	200

BR4230 / Ø 42mm

DRAWING (mm)

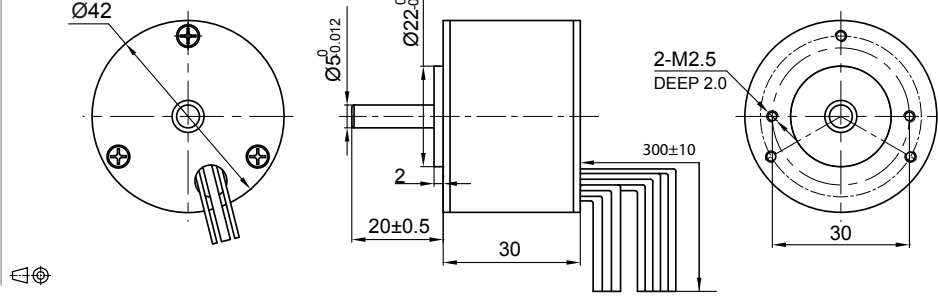

PHOTO



HALL CONNECTING

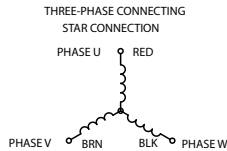
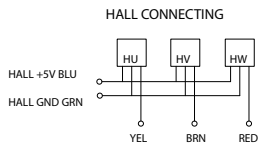

MODEL NO. DESIGNATION

MODEL - VOLTAGE

Example: BR4230-12

MOTOR DATA

	Units	BR4230-12	BR4230-24		Units	BR4230
Nominal voltage	V	12	24	Ambient temperature	°C	-15...+40
Nominal power	W	10	8.4	Max. permissible winding temperature	°C	120
No load speed	rpm	6600	5500	Max. permissible speed	rpm	15000
No load current	mA	40	40	Axial play at axial load < 3,5 N	mm	0.07
Nominal speed	rpm	5000	4000	Axial play at axial load > 3,5 N	mm	0.07
Nominal torque	mNm	24	24	Radial play	mm@g	0.02@450
Nominal current	A	1.6	2	Max. axial load (dynamic)	N	4.4
Stall torque	mNm	60	60	Max. force for press fits (static)	N	4.4
Max. Efficiency	%	55	60	Max. force for press fits (static, shaft supported)	N	4.4
Terminal resistance phase to phase	Ω	1.08	5.9	Max. radial loading, 10 mm from flange	N	4
Terminal inductance phase to phase	mH	0.84	5.1	Number of pole pairs		8
Torque constant	mNm / A	16.12	48.7	Number of phases		3
Rotor inertia	gcm ²	24	24	Weight	g	250

BR4260 / Ø 42mm

DRAWING (mm)

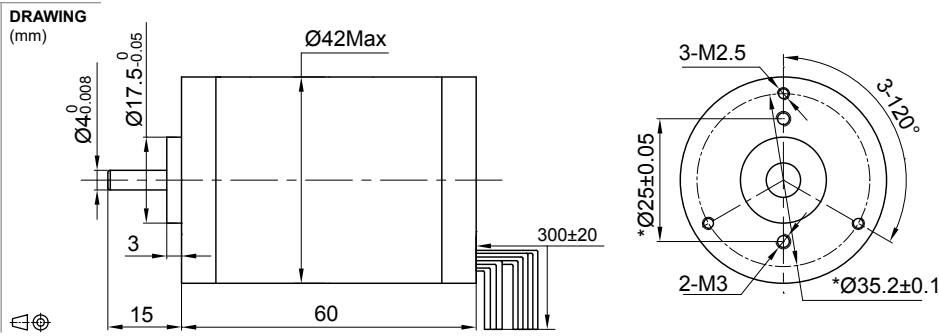

PHOTO



HALL CONNECTING

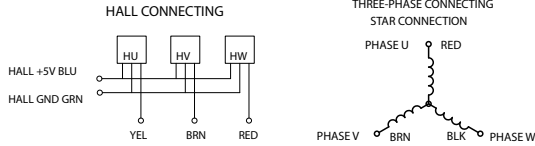

MODEL NO. DESIGNATION

MODEL - VOLTAGE

Example: BR4260-12

MOTOR DATA

	Units	BR4260-12	BR4260-24		Units	BR4260
Nominal voltage	V	12	24	Ambient temperature	°C	-15...+40
Nominal power	W	25	25	Max. permissible winding temperature	°C	120
No load speed	rpm	5800	5600	Max. permissible speed	rpm	15000
No load current	mA	50	50	Axial play at axial load < 3,5 N	mm	0.06
Nominal speed	rpm	4200	4200	Axial play at axial load > 3,5 N	mm	0.06
Nominal torque	mNm	67	67	Radial play	mm@g	0.02@450
Nominal current	A	3.2	6.5	Max. axial load (dynamic)	N	4.4
Stall torque	mNm	210	240	Max. force for press fits (static)	N	4.4
Max. Efficiency	%	65	72	Max. force for press fits (static, shaft supported)	N	4.4
Terminal resistance phase to phase	Ω	0.48	1.6	Max. radial loading, 10 mm from flange	N	4
Terminal inductance phase to phase	mH	0.44	1.94	Number of pole pairs		8
Torque constant	mNm / A	19.73	38.5	Number of phases		3
Rotor inertia	gcm ²	48	48	Weight	g	400

BR4285 / Ø 42mm

DRAWING (mm)

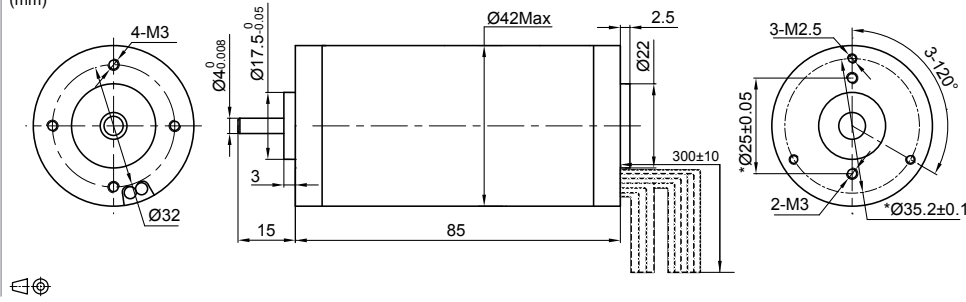

PHOTO



HALL CONNECTING

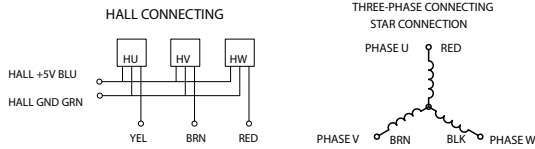

MODEL NO. DESIGNATION

MODEL - VOLTAGE

Example: BR4285-12

MOTOR DATA

	Units	BR4285-24		Units	BR4285
Nominal voltage	V	24	Ambient temperature	°C	-15...+40
Nominal power	W	62	Max. permissible winding temperature	°C	120
No load speed	rpm	6000	Max. permissible speed	rpm	15000
No load current	mA	65	Axial play at axial load < 3,5 N	mm	0.06
Nominal speed	rpm	4000	Axial play at axial load > 3,5 N	mm	0.06
Nominal torque	mNm	180	Radial play	mm@g	0.02@450
Nominal current	A	12	Max. axial load (dynamic)	N	4.4
Stall torque	mNm	450	Max. force for press fits (static)	N	4.4
Max. Efficiency	%	73	Max. force for press fits (static, shaft supported)	N	4.4
Terminal resistance phase to phase	Ω	0.71	Max. radial loading, 10 mm from flange	N	4
Terminal inductance phase to phase	mH	0.86	Number of pole pairs		8
Torque constant	mNm / A	38.6	Number of phases		3
Rotor inertia	gcm ²	84	Weight	g	700

BR4293 / Ø 42mm

DRAWING (mm)

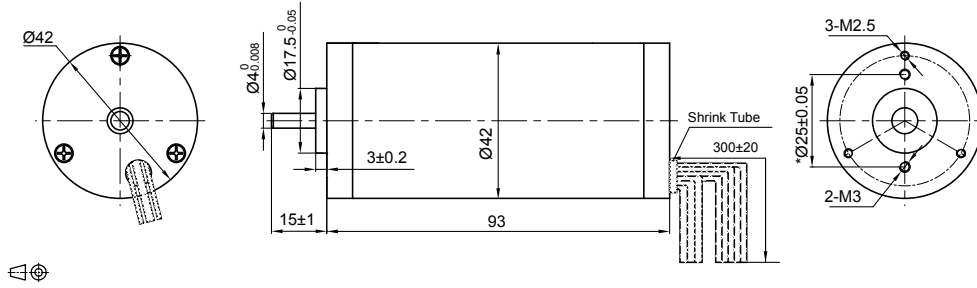

PHOTO



HALL CONNECTING

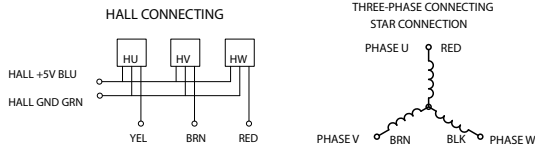

MODEL NO. DESIGNATION

MODEL - VOLTAGE

Example: BR4293-12

MOTOR DATA

	Units	BR4293-24		Units	BR4293
Nominal voltage	V	24	Ambient temperature	°C	-15...+40
Nominal power	W	75	Max. permissible winding temperature	°C	120
No load speed	rpm	8000	Max. permissible speed	rpm	15000
No load current	mA	85	Axial play at axial load < 3,5 N	mm	0.06
Nominal speed	rpm	6300	Axial play at axial load > 3,5 N	mm	0.06
Nominal torque	mNm	138	Radial play	mm@g	0.02@450
Nominal current	A	20	Max. axial load (dynamic)	N	4.4
Stall torque	mNm	500	Max. force for press fits (static)	N	4.4
Max. Efficiency	%	75	Max. force for press fits (static, shaft supported)	N	4.4
Terminal resistance phase to phase	Ω	0.325	Max. radial loading, 10 mm from flange	N	4
Terminal inductance phase to phase	mH	0.36	Number of pole pairs		8
Torque constant	mNm / A	28.7	Number of phases		3
Rotor inertia	gcm ²	94	Weight	g	800

BR5743 / Ø 57mm

DRAWING (mm)

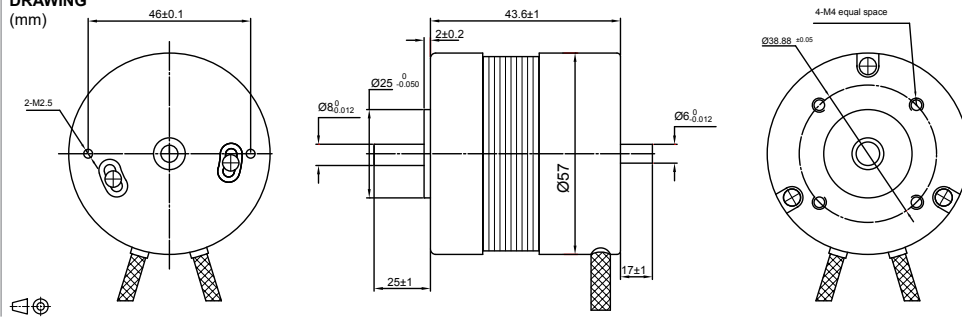

PHOTO



HALL CONNECTING

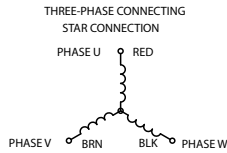
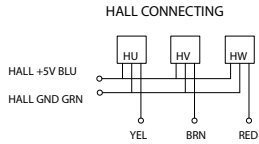

MODEL NO. DESIGNATION

MODEL - VOLTAGE

Example: BR5743-12

MOTOR DATA

	Units	BR5743-12	BR5743-24		Units	BR5743
Nominal voltage	V	12	24	Ambient temperature	°C	-15...+40
Nominal power	W	22	23	Max. permissible winding temperature	°C	130
No load speed	rpm	5800	5900	Max. permissible speed	rpm	13000
No load current	mA	600	400	Radial play	mm@g	0.025@460
Nominal speed	rpm	4000	4000	Max. axial load (dynamic)	N	15
Nominal torque	mNm	55	55	Max. radial loading, 10 mm from flange	N	75
Nominal current	A	3.27	1.92	Number of pole pairs		2
Stall torque	mNm	165	165	Number of phases		3
Max. Efficiency	%	60	49	Weight	g	250
Terminal resistance phase to phase	Ω	0.56	2.06			
Terminal inductance phase to phase	mH	1.09	4.1			
Torque constant	mNm / A	18	35			
Rotor inertia	gcm ²	30	30			

BR5753 / Ø 57mm

DRAWING (mm)

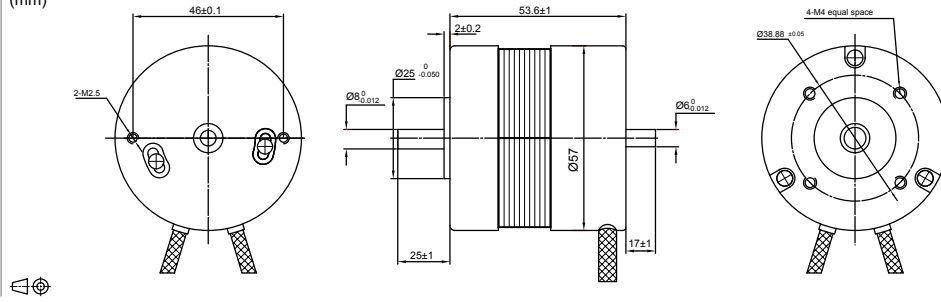

PHOTO



HALL CONNECTING

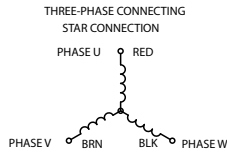
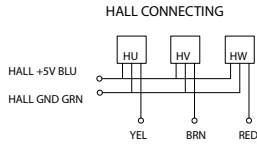

MODEL NO. DESIGNATION

MODEL - VOLTAGE

Example: BR5753-12

MOTOR DATA

	Units	BR5753-12	BR5753-24		Units	BR5753
Nominal voltage	V	12	24	Ambient temperature	°C	-15...+40
Nominal power	W	39	41	Max. permissible winding temperature	°C	120
No load speed	rpm	5600	5400	Max. permissible speed	rpm	13000
No load current	mA	600	500	Radial play	mm@g	0.025@460
Nominal speed	rpm	4000	4000	Max. axial load (dynamic)	N	15
Nominal torque	mNm	100	110	Max. radial loading, 10 mm from flange	N	75
Nominal current	A	7.2	2.17	Number of pole pairs		2
Stall torque	mNm	300	330	Number of phases		3
Max. Efficiency	%	53	75	Weight	g	500
Terminal resistance phase to phase	Ω	0.23	0.82			
Terminal inductance phase to phase	mH	0.45	2.3			
Torque constant	mNm / A	14	38.7			
Rotor inertia	gcm ²	75	75			

BR5773 / Ø 57mm

DRAWING (mm)

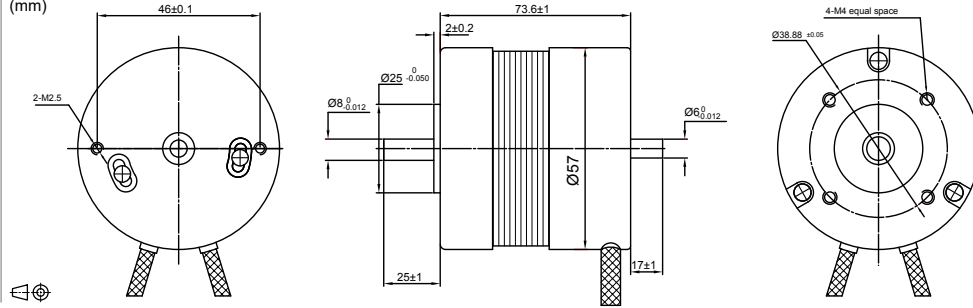

PHOTO



HALL CONNECTING

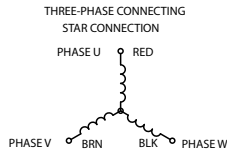
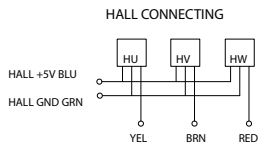

MODEL NO. DESIGNATION

MODEL - VOLTAGE

Example: BR5773-12

MOTOR DATA

	Units	BR5773-12	BR5773-24	Units	BR5773
Nominal voltage	V	12	24	Ambient temperature	°C
Nominal power	W	94	81	Max. permissible winding temperature	°C
No load speed	rpm	6100	5300	Max. permissible speed	rpm
No load current	mA	1200	550	Radial play	mm@g
Nominal speed	rpm	4000	4000	Max. axial load (dynamic)	N
Nominal torque	mNm	220	220	Max. radial loading, 10 mm from flange	N
Nominal current	A	12.43	3.67	Number of pole pairs	
Stall torque	mNm	660	660	Number of phases	
Max. Efficiency	%	70	75	Weight	g
Terminal resistance phase to phase	Ω	0.085	0.35		
Terminal inductance phase to phase	mH	0.2	1		
Torque constant	mNm / A	19.4	43		
Rotor inertia	gcm ²	119	119		

BR5793 / Ø 57mm

DRAWING (mm)

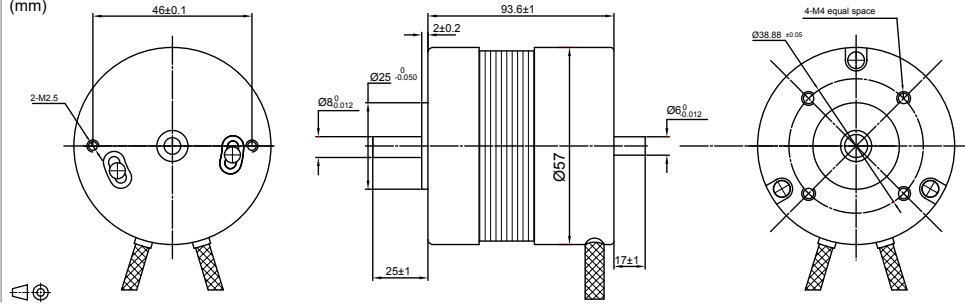

PHOTO



HALL CONNECTING

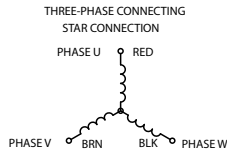
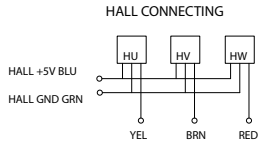

MODEL NO. DESIGNATION

MODEL - VOLTAGE

Example: BR5793-12

MOTOR DATA

	Units	BR5793-12	BR5793-24		Units	BR5793
Nominal voltage	V	12	24	Ambient temperature	°C	-15...+40
Nominal power	W	127	120	Max. permissible winding temperature	°C	130
No load speed	rpm	5500	5200	Max. permissible speed	rpm	13000
No load current	mA	1200	700	Radial play	mm@g	0.025@460
Nominal speed	rpm	4000	4000	Max. axial load (dynamic)	N	15
Nominal torque	mNm	330	330	Max. radial loading, 10 mm from flange	N	75
Nominal current	A	19	8.43	Number of pole pairs		2
Stall torque	mNm	990	990	Number of phases		3
Max. Efficiency	%	60	70	Weight	g	1000
Terminal resistance phase to phase	Ω	0.064	0.19			
Terminal inductance phase to phase	mH	0.15	0.61			
Torque constant	mNm / A	24	39.7			
Rotor inertia	gcm ²	173	173			

BR57115 / Ø 57mm

DRAWING (mm)

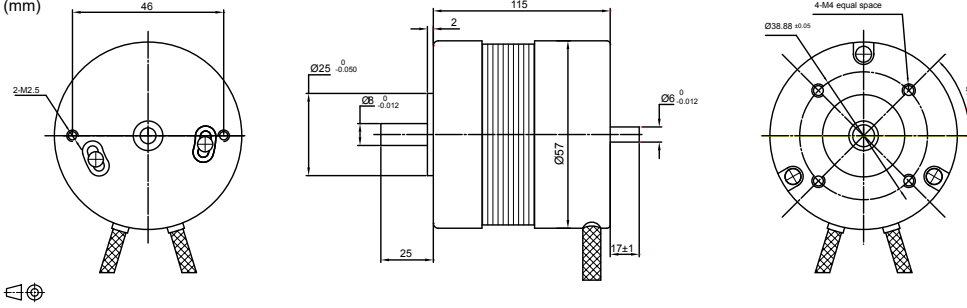

PHOTO



HALL CONNECTING

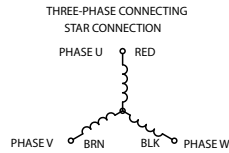
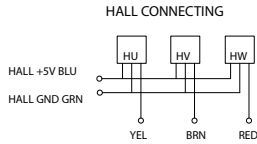

MODEL NO. DESIGNATION

MODEL - VOLTAGE

Example: BR57115-12

MOTOR DATA

	Units	BR57115-24	Units	BR57115
Nominal voltage	V	24	Ambient temperature	°C -15...+40
Nominal power	W	172	Max. permissible winding temperature	°C 130
No load speed	rpm	5600	Max. permissible speed	rpm 10000
No load current	mA	400	Radial play	mm@g 0.025@460
Nominal speed	rpm	4000	Max. axial load (dynamic)	N 15
Nominal torque	mNm	440	Max. radial loading, 10 mm from flange	N 75
Nominal current	A	11	Number of pole pairs	2
Stall torque	mNm	1320	Number of phases	3
Max. Efficiency	%	70	Weight	g 1250
Terminal resistance phase to phase	Ω	0.16		
Terminal inductance phase to phase	mH	0.44		
Torque constant	mNm / A	39		
Rotor inertia	gcm ²	230		

B4240 / Ø 42mm

DRAWING (mm)

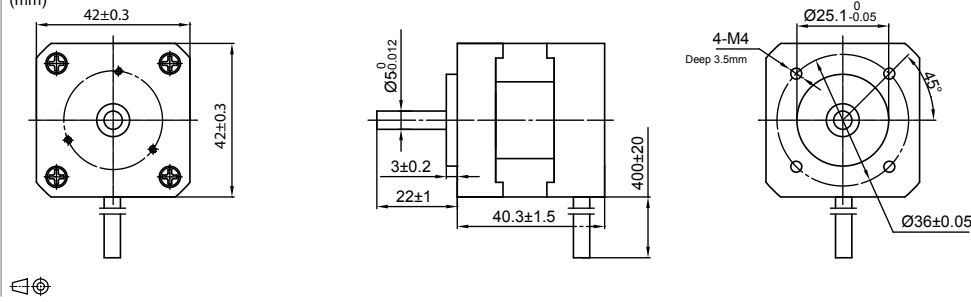

PHOTO

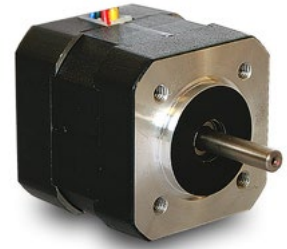

HALL CONNECTING

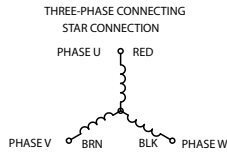
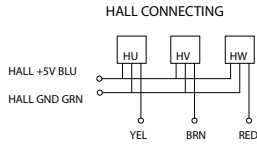

MODEL NO. DESIGNATION

MODEL - VOLTAGE

Example: B4240-12

MOTOR DATA

	Units	B4240-12	B4240-24		Units	B4240
Nominal voltage	V	12	24	Ambient temperature	°C	-15...+40
Nominal power	W	26	26	Max. permissible winding temperature	°C	120
No load speed	rpm	6800	6500	Max. permissible speed	rpm	20000
No load current	mA	600	500	Axial play at axial load < 3,5 N	mm	0,1
Nominal speed	rpm	4000	4000	Axial play at axial load > 3,5 N	mm	0,6
Nominal torque	mNm	75	75	Radial play	mm@g	0.025@460
Nominal current	A	3,9	2	Max. axial load (dynamic)	N	10
Stall torque	mNm	200	240	Max. force for press fits (static)	N	200
Starting current	A	8,4	6,8	Max. force for press fits (static, shaft supported)	N	200
Max. Efficiency	%	59,1	64,5	Max. radial loading, 10 mm from flange	N	28
Terminal resistance phase to phase	Ω	0,42	1,5	Number of pole pairs		4
Terminal inductance phase to phase	mH	0,53	2,1	Number of phases		3
Torque constant	mNm / A	0,15	35	Weight	g	300
Speed constant	rpm / V	791	408			
Mechanical time constant	ms	9	9,01			
Rotor inertia	gcm ²	24	24			

B4260 / Ø 42mm

DRAWING (mm)

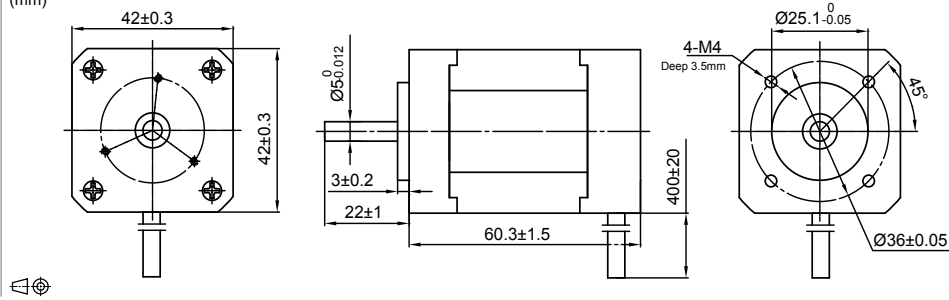

PHOTO

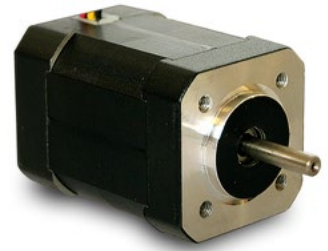

HALL CONNECTING

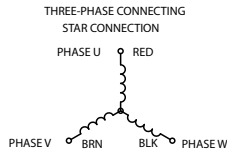
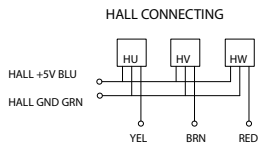

MODEL NO. DESIGNATION

MODEL - VOLTAGE

Example: B4260-12

MOTOR DATA

	Units	B4260-12	B4260-24		Units	B4260
Nominal voltage	V	12	24	Ambient temperature	°C	-15...+40
Nominal power	W	52	52	Max. permissible winding temperature	°C	120
No load speed	rpm	6200	6000	Max. permissible speed	rpm	20000
No load current	mA	600	500	Axial play at axial load < 3,5 N	mm	0,1
Nominal speed	rpm	4000	4000	Axial play at axial load > 3,5 N	mm	0,6
Nominal torque	mNm	150	150	Radial play	mm@g	0.025@460
Nominal current	A	6,2	3,2	Max. axial load (dynamic)	N	10
Stall torque	mNm	350	380	Max. force for press fits (static)	N	200
Starting current	A	16,8	12,8	Max. force for press fits (static, shaft supported)	N	200
Max. Efficiency	%	67,8	72,3	Max. radial loading, 10 mm from flange	N	28
Terminal resistance phase to phase	Ω	0,2	0,8	Number of pole pairs		4
Terminal inductance phase to phase	mH	0,24	1,2	Number of phases		3
Torque constant	mNm / A	0,16	35,5	Weight	g	450
Speed constant	rpm / V	855	369			
Mechanical time constant	ms	7,8	7,85			
Rotor inertia	gcm ²	48	48			

B4280 / Ø 42mm

DRAWING (mm)

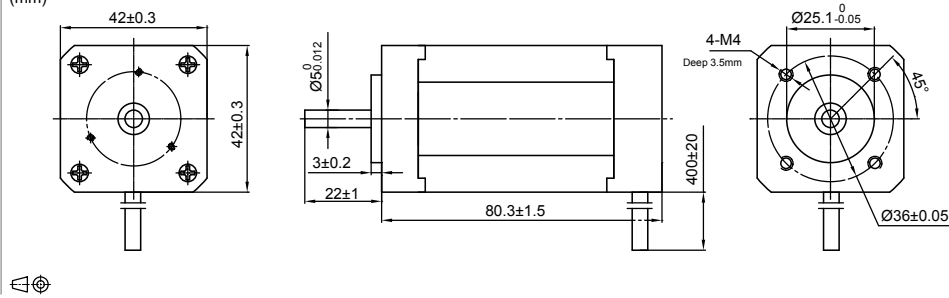

PHOTO



HALL CONNECTING

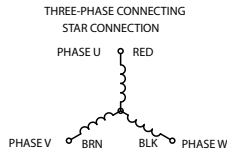
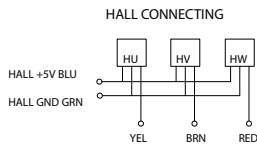

MODEL NO. DESIGNATION

MODEL - VOLTAGE

Example: B4280-12

MOTOR DATA

	Units	B4280-24	Units	B4280
Nominal voltage	V	24	Ambient temperature	°C -15...+40
Nominal power	W	78	Max. permissible winding temperature	°C 120
No load speed	rpm	6100	Max. permissible speed	rpm 20000
No load current	mA	500	Axial play at axial load < 3,5 N	mm 0,1
Nominal speed	rpm	4000	Axial play at axial load > 3,5 N	mm 0,6
Nominal torque	mNm	220	Max. axial load (dynamic)	N 10
Nominal current	A	4,7	Max. force for press fits (static)	N 200
Stall torque	mNm	560	Max. force for press fits (static, shaft supported)	N 200
Starting current	A	19,8	Max. radial loading, 10 mm from flange	N 28
Max. Efficiency	%	76,8	Number of pole pairs	4
Terminal resistance phase to phase	Ω	0,43	Number of phases	3
Terminal inductance phase to phase	mH	0,71	Weight	g 650
Torque constant	mNm / A	38		
Speed constant	rpm / V	365		
Mechanical time constant	ms	6,87		
Rotor inertia	gcm ²	72		

B42100 / Ø 42mm

DRAWING (mm)

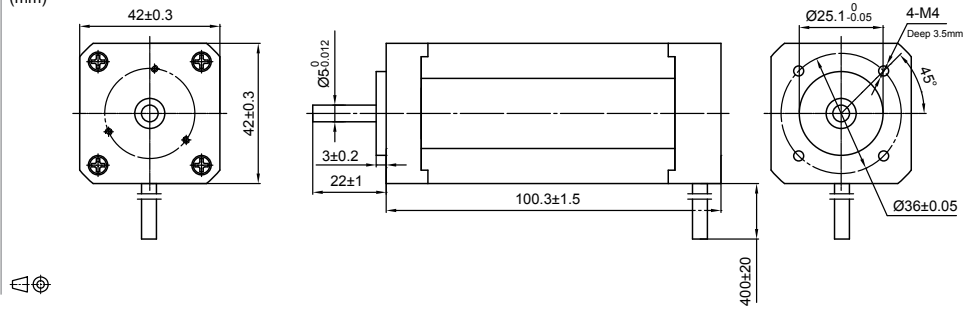

PHOTO



HALL CONNECTING

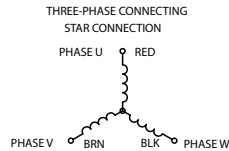
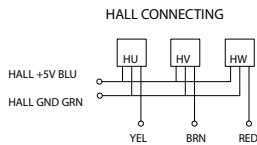

MODEL NO. DESIGNATION

MODEL - VOLTAGE

Example: B42100-12

MOTOR DATA

	Units	B42100-24	Units	B42100
Nominal voltage	V	24	Ambient temperature	°C -15...+40
Nominal power	W	105	Max. permissible winding temperature	°C 120
No load speed	rpm	6300	Max. permissible speed	rpm 20000
No load current	mA	500	Axial play at axial load < 3,5 N	mm 0,1
Nominal speed	rpm	4000	Axial play at axial load > 3,5 N	mm 0,6
Nominal torque	mNm	300	Max. axial load (dynamic)	N 10
Nominal current	A	6,5	Max. force for press fits (static)	N 200
Stall torque	mNm	750	Max. force for press fits (static, shaft supported)	N 200
Starting current	A	25,4	Max. radial loading, 10 mm from flange	N 28
Max. Efficiency	%	77,4	Number of pole pairs	4
Terminal resistance phase to phase	Ω	0,3	Number of phases	3
Terminal inductance phase to phase	mH	0,49	Weight	g 800
Torque constant	mNm / A	35,5		
Speed constant	rpm / V	382		
Mechanical time constant	ms	7,53		
Rotor inertia	gcm ²	96		

B5755 / Ø 57mm

DRAWING (mm)

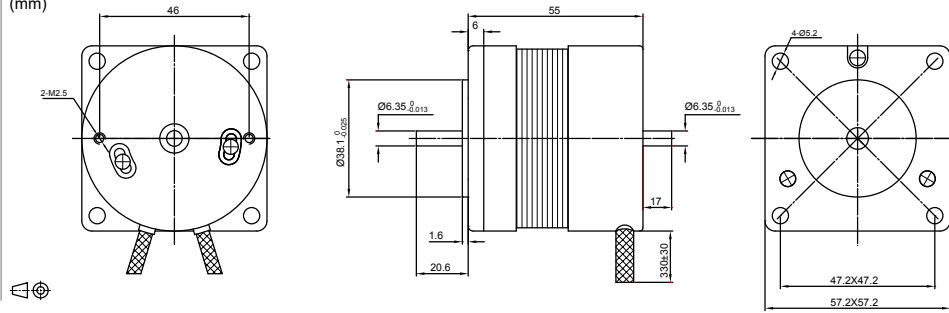

PHOTO

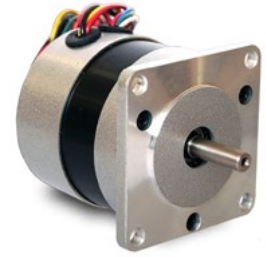

HALL CONNECTING

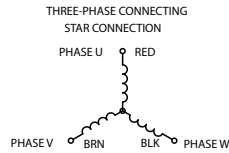
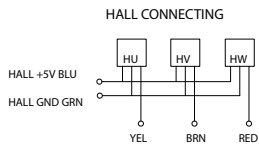

MODEL NO. DESIGNATION

MODEL - VOLTAGE

Example: B5755-12

MOTOR DATA

	Units	B5755-24	Units	B5755
Nominal voltage	V	24	Ambient temperature	°C -15-...+40
Nominal power	W	52	Max. permissible winding temperature	°C 130
No load speed	rpm	5400	Max. permissible speed	rpm 13000
No load current	mA	500	Radial play	mm@g 0.025@460
Nominal speed	rpm	4000	Max. axial load (dynamic)	N 15
Nominal torque	mNm	110	Max. radial loading, 10 mm from flange	N 15
Nominal current	A	2.17	Number of pole pairs	2
Stall torque	mNm	330	Number of phases	3
Max. efficiency	%	75	Weight	g 500
Terminal resistance phase to phase	Ω	0.82		
Terminal inductance phase to phase	mH	2.3		
Torque constant	mNm / A	38.7		
Rotor inertia	gcm ²	75		

B8672 / Ø 86mm

DRAWING (mm)

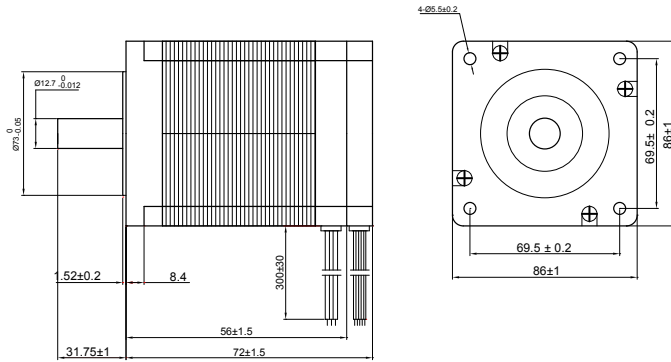

PHOTO



HALL CONNECTING

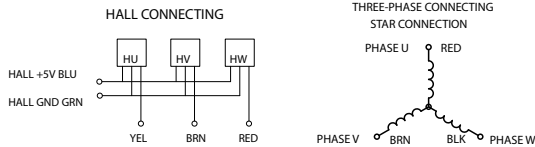

MODEL NO. DESIGNATION

MODEL - VOLTAGE

Example: B8672-12

MOTOR DATA

	Units	B8672-12	B8672-24	B8672-48		Units	B8672
Nominal voltage	V	12	24	48	Nominal voltage	V	12 24 48
Nominal power	W	117	112	117	Ambient temperature	°C	-15...+40
No load speed	rpm	4500	3500	3700	Max. permissible winding temperature	°C	140 140 120
No load current	mA	5500	1400	600	Max. permissible speed	rpm	5000
Nominal speed	rpm	3201	2994	3102	Axial play at axial load < 3,5 N	mm	0,1
Nominal torque	Nm	0.349	0.357	0.359	Axial play at axial load > 3,5 N	mm	0,6
Nominal current	A	14.95	47	19.4	Radial play	mm@g	0,02
Stall torque	Nm	1.2	2.45	2.2	Max. axial load (dynamic)	N	60
Starting current	A	49.5	47	19.4	Max. force for press fits (static)	N	560
Max. efficiency	%	66.6	63.2	74.3	Max. force for press fits (static, shaft)	N	2000
Terminal resistance phase to phase	Ω	0.066	0.21	0.98	Max. radial loading, 10 mm from flange	N	220
Terminal inductance phase to phase	mH	0.12	0.51	2.58	Number of pole pairs		4
Torque constant	Nm / A	0.0248	0.053	0.114	Number of phases		3
Speed constant	rpm / V	375	146	77	Weight	g	1600
Speed / torque gradient	rpm / Nm	3750	1428	1682			
Mechanical time constant	ms	16	6.1	7.2			
Rotor inertia	gcm ²	400	400	400			

B8686 / Ø 86mm

DRAWING (mm)

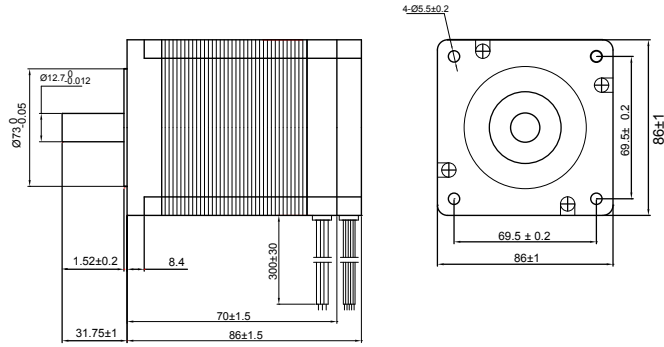

PHOTO



HALL CONNECTING

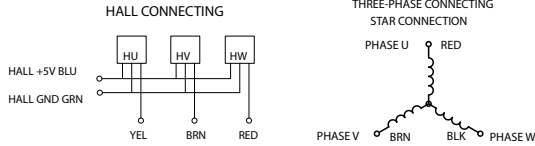

MODEL NO. DESIGNATION

MODEL - VOLTAGE

Example: B8686-12

MOTOR DATA

	Units	B8686-12	B8686-24	B8686-48		Units	B8686
Nominal voltage	V	12	24	48	Nominal voltage	V	12 24 48
Nominal power	W	116	225	228	Ambient temperature	°C	-15...+40
No load speed	rpm	2600	3900	3750	Max. permissible winding temperature	°C	140 140 120
No load current	mA	1800	1400	950	Max. permissible speed	rpm	5000
Nominal speed	rpm	1817	3062	3107	Axial play at axial load < 3,5 N	mm	0,1
Nominal torque	Nm	0.609	0.703	0.702	Axial play at axial load > 3,5 N	mm	0,6
Nominal current	A	14.43	13.76	6.61	Radial play	mm@g	0,02
Stall torque	Nm	2	3.2	4	Max. axial load (dynamic)	N	60
Starting current	A	51	56	34	Max. force for press fits (static)	N	560
Max. efficiency	%	75	70	73	Max. force for press fits (static, shaft)	N	2000
Terminal resistance phase to phase	Ω	0.056	0.091	0.34	Max. radial loading, 10 mm from flange	N	220
Terminal inductance phase to phase	mH	0.127	0.23	1	Number of pole pairs		4
Torque constant	Nm / A	0.04	0.059	0.12	Number of phases		3
Speed constant	rpm / V	217	162	78	Weight	g	2120
Speed / torque gradient	rpm / Nm	1300	1218	948			
Mechanical time constant	ms	11.1	12.7	8			
Rotor inertia	gcm ²	800	800	800			

B86112 / Ø 86mm

DRAWING (mm)

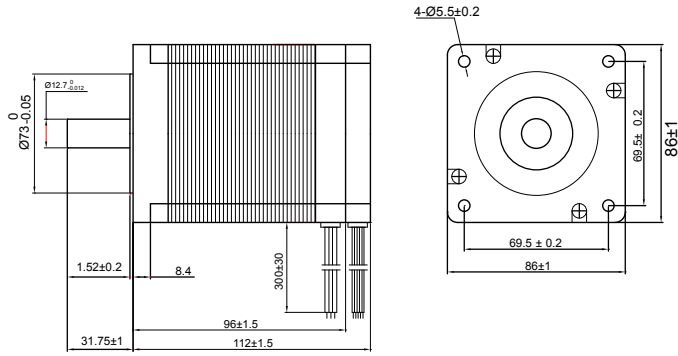

PHOTO



HALL CONNECTING

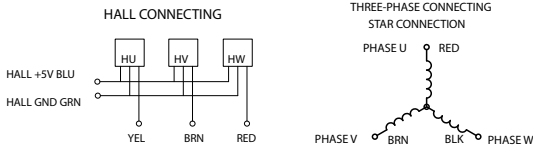

MODEL NO. DESIGNATION

MODEL - VOLTAGE

Example: B86112-12

MOTOR DATA

	Units	B86112-24	B86112-48		Units	B86112
Nominal voltage	V	24	48	Nominal voltage	V	24 48
Nominal power	W	393	436	Ambient temperature	°C	--15...+40
No load speed	rpm	3870	3600	Max. permissible winding temperature	°C	140 120
No load current	mA	2400	1200	Max. permissible speed	rpm	5000
Nominal speed	rpm	3126	2975	Axial play at axial load < 3,5 N	mm	0,1
Nominal torque	Nm	1.2	1.4	Axial play at axial load > 3,5 N	mm	0,6
Nominal current	A	23	11.8	Radial play	mm@g	0,02
Stall torque	Nm	6.2	8	Max. axial load (dynamic)	N	60
Starting current	A	108	62	Max. force for press fits (static)	N	560
Max. efficiency	%	74.1	77.6	Max. force for press fits (static, shaft)	N	2000
Terminal resistance phase to phase	Ω	0.04	0.16	Max. radial loading, 10 mm from flange	N	220
Terminal inductance phase to phase	mH	0.096	0.5	Number of pole pairs		4
Torque constant	Nm / A	0.0586	0.13	Number of phases		3
Speed constant	rpm / V	160	75	Weight	g	3150
Speed / torque gradient	rpm / Nm	624	450			
Mechanical time constant	ms	10.6	7.7			
Rotor inertia	gcm ²	1600	1600			

B86139 / Ø 86mm

DRAWING (mm)

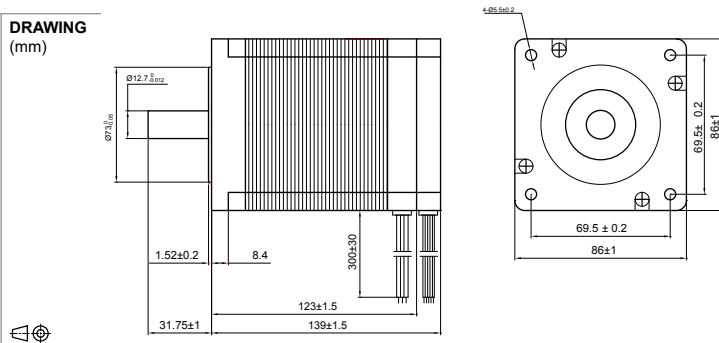

PHOTO



HALL CONNECTING

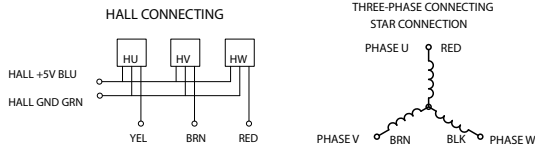

MODEL NO. DESIGNATION

MODEL - VOLTAGE

Example: B86139-12

MOTOR DATA

	Units	B86139-48	B86139
Nominal voltage	V	48	
Nominal power	W	657	
No load speed	rpm	3600	
No load current	mA	1900	
Nominal speed	rpm	2990	
Nominal torque	Nm	2,098	
Nominal current	A	16,5	
Stall torque	Nm	18500	
Starting current	A	138	
Max. efficiency	%	84	
Terminal resistance phase to phase	Ω	0,07	
Terminal inductance phase to phase	mH	0,103	
Torque constant	Nm / A	112	
Speed constant	rpm / V	110	
Speed / torque gradient	rpm / Nm	0,21	
Mechanical time constant	ms	4,83	
Rotor inertia	gcm ²	2400	
Ambient temperature	°C	-15°C ---- 48	
Max. permissible winding temperature	°C	120	
Max. permissible speed	rpm	5000	120
Axial play at axial load < 3,5 N	mm	0,1	
Axial play at axial load > 3,5 N	mm	0,6	
Radial play	mm@g	0,02	
Max. axial load (dynamic)	N	60	
Max. force for press fits (static)	N	560	
Max. force for press fits (static, shaft)	N	2000	
Max. radial loading, 10 mm from flange	N	220	
Number of pole pairs		4	
Number of phases		3	
Weight	g	4100	